

PRINCES SQUARE

BY **M**

LEASING BROCHURE

SHOP



DINE



MEET



UNDER
NEW
OWNERSHIP
SINCE
JAN 2024

RECENT LETTINGS:

The Club House | All Saints | & Other Stories | Bloom



Welcome to Princes Square,
Glasgow's finest destination
to shop, dine and socialise,
set within a prime position
on Buchanan Street.

WELCOME

Located at the heart of Buchanan Street, our iconic 19th century building was voted Scotland's favourite historic building in 2017 and offers unrivalled premium surroundings in Glasgow for a unique shopping experience. The mix of quality food and beverage options with a high-quality tenant mix makes it the indoor location of choice for Glasgow's aspirational shopper.



LOCATION

- 4th largest city in the UK
- Scotland's best retailing destination
- In the heart of Glasgow city centre accessed from both Buchanan Street & Queen Street.
- No vacancy on Buchanan Street.

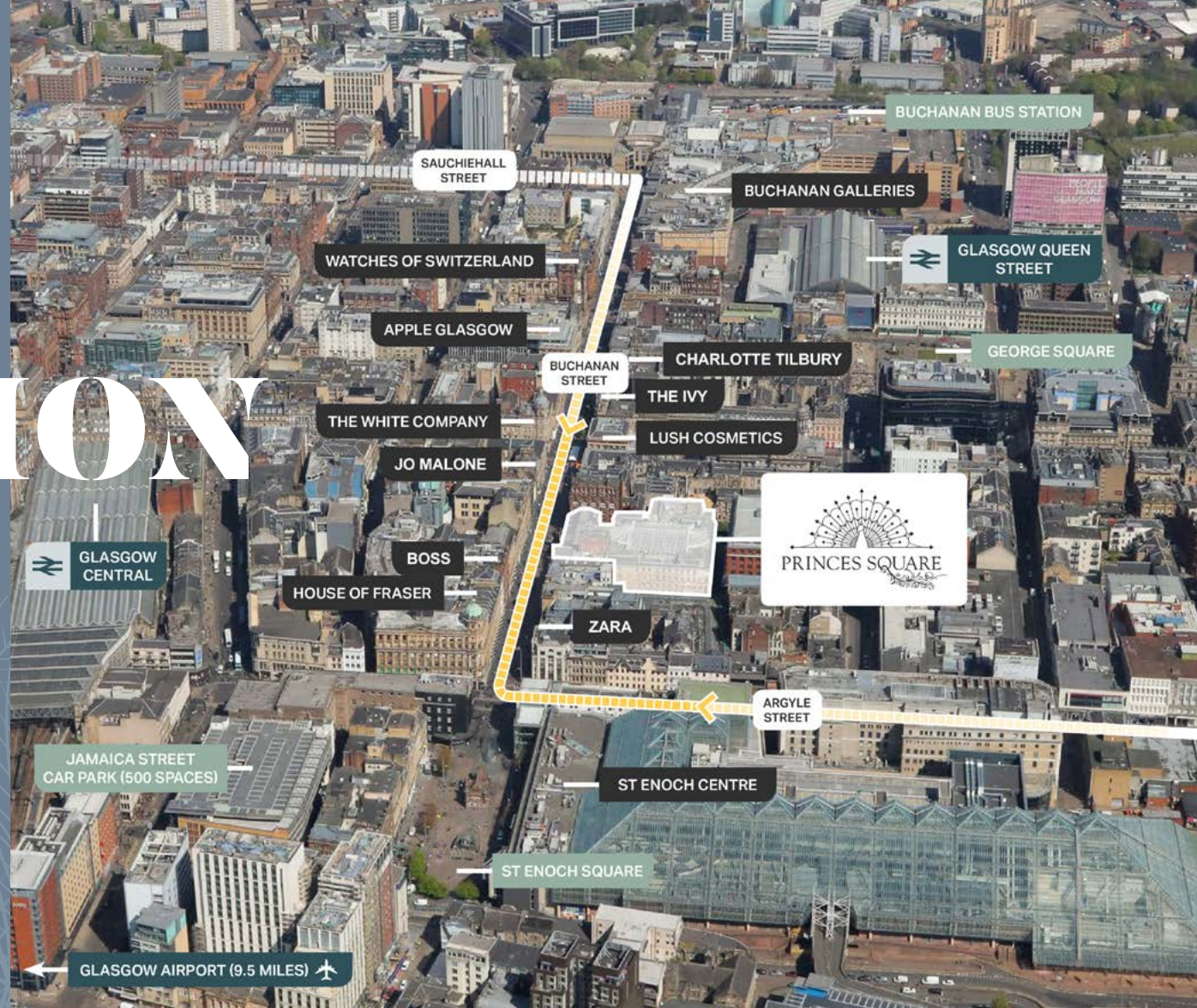

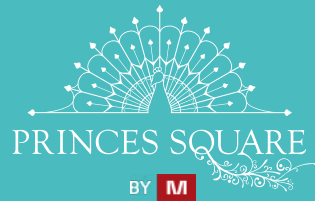

OUR SHOPPERS

These groups spend more than £1,000 per capita on clothing and footwear, which represents strong local demand for the premium fashion brands at Princes Square.

The Wealthy Executives group is also well-represented within the catchment, adding a further spend of £950 per annum. It is important not to overlook the less affluent catchment, as this spend is often even more due to the status associated with fashion and brand affiliation.

*ACORN is a consumer classification that segments the UK population.

Princes Square focuses on the four highest spending ACORN* groups:

- **Educated Urbanites**
- **Prosperous Professionals**
- **Wealthy Executives**
- **Aspiring Singles**





- The city ranks second only to London's West End in the UK Retail Ranking.

Source: Geolytix, May 2024.



- Active frontage onto Scotland's prime retail pitch.



5

floors of retail and hospitality

118,625 SQFT

of quality accomodation

22.5k

website visits per month







£928

Average retail density per sq. ft.

Glasgow remains within the UK's top 10 retail centres

Source: GMAP Analytics

BRANDS

	ARGENTO	ALLSAINTS	<i>& other stories</i>	barça
	CARVELA	COS		DIAMOND HEAVEN
DOWER & HALL		EVERYMAN	IL PAVONE <small>EST 1991 ITALIAN RESTAURANT & BAR</small>	kate spade <small>NEW YORK</small>
KURT GEIGER	MAISON <small>by GLASCHU</small>	OCTOBER <small>ROOFTOP - CAFE - TERRACE - LATE BAR</small>	REISS	<i>Shirk Fleet.</i>
SPACE NK.apothecary	Sweaty Betty <small>LONDON</small>	 TIMOTHY OULTON	TINDERBOX <small>RESTAURANT</small>	



Princes Square has seen consistent long-term commitment from aspirational tenants

FLOOR PLANS



The Courtyard

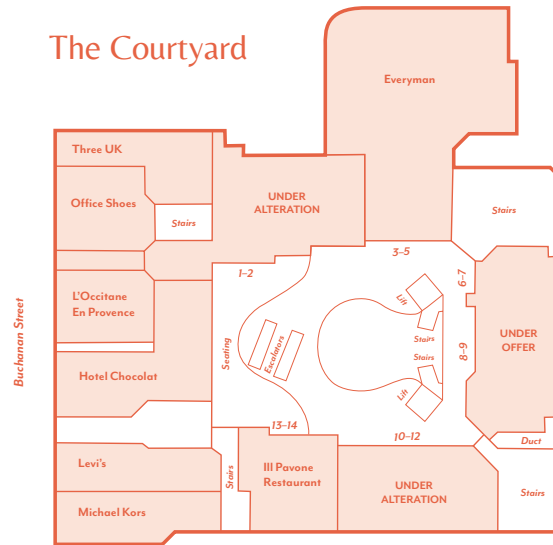

Ground Floor

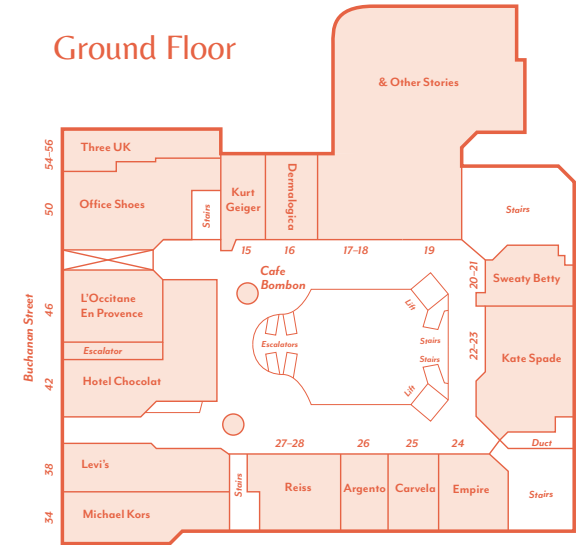

First Floor

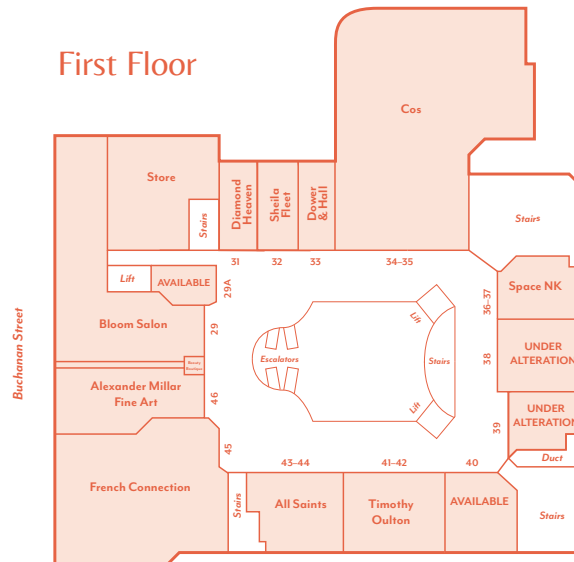

Terrace

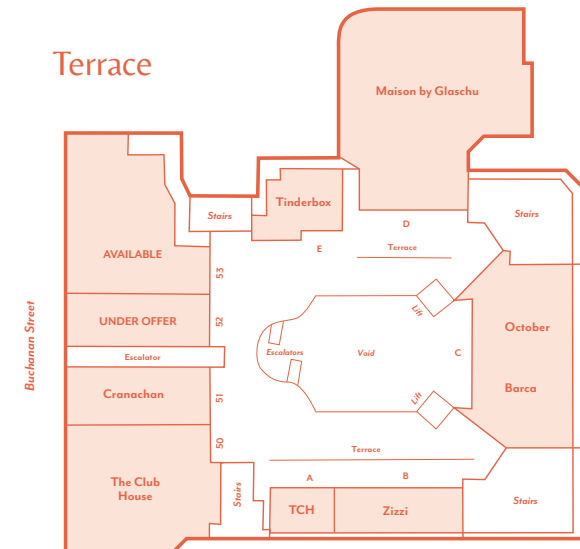



CONTACT

Rakesh Joshi

T +44 (0)7741 385 322

E rjoshi@lcpproperties.co.uk

LCP
part of M Core

01384
400123



searchlcp.co.uk

Alex Williams

M +44 (0)7741 951843

E awilliams@lcpproperties.co.uk

Stuart Moncur

M +44 (0)7887 795 506

E stuart.moncur@savills.com



Charlie Hall

M +44 (0)7807 999 693

E charlie.hall@savills.com

James Godfrey

M +44 (0)7768 190114

E james@culverwell.co.uk

Culverwell

0131 226 6611
www.culverwell.co.uk

SHOP

DINE

MEET

@princesssquare

@princesssquare



Savills and Culverwell for themselves and for the vendors or lessors of this property for whom they act, give notice that: (i) these particulars are a general outline only, for the guidance of prospective purchasers or tenants, and do not constitute the whole or any part of any offer or contract; (ii) Savills and Culverwell cannot guarantee the accuracy of any description, dimensions, references to condition, necessary permissions for use and occupation and other details contained herein and prospective purchasers or tenants must not rely on them as statements of fact or representations and must satisfy themselves as to their accuracy; (iii) no employee of Savills and Culverwell has any authority to make or give any representation or warranty or enter into any contract whatever in relation to this property; (iv) rents quoted in these particulars may be subject to VAT in addition; and (v) Savills and Culverwell will not be liable, in negligence or otherwise, for any loss arising from the use of these particulars. Consumer Protection from Unfair Trading Regulations 2008 and Business Protection from Misleading Marketing Regulations 2008: Every reasonable effort has been made by Savills and Culverwell to ensure accuracy and to check the facts contained in these particulars are complete. Interested parties are strongly advised to take appropriate steps to verify by independent inspection or enquiry all information for themselves and to take appropriate professional advice. Designed & produced by Maguire.

princesssquare.co.uk

SEPTEMBER 2024